

**RUSH
WITT &
WILSON**



RUSH
WITT &

**40 Lower Park Road, Hastings, TN34 2LA
£150,000 Freehold**

Nestled on Lower Park Road in Hastings, this charming one-bedroom ground floor flat offers a unique opportunity for those looking to create their dream home. Situated directly opposite the picturesque Alexandra Park, residents can enjoy the beauty of nature right at their doorstep. This period conversion flat boasts spacious accommodation, providing ample room for comfortable living.

The property features one reception room, perfect for relaxing or entertaining guests, and a well-proportioned bedroom that invites natural light. The bathroom, while in need of some modernisation, presents a blank canvas for your personal touch. One of the standout features of this property is the outside space, which offers potential for a lovely garden or outdoor seating area, ideal for enjoying the fresh air during warmer months. As a CHAIN FREE property, this flat presents a straightforward buying process, making it an attractive option for first-time buyers or investors looking to add to their portfolio. With a little renovation, this flat can be transformed into a delightful home that reflects your style and preferences.

Do not miss the chance to explore the potential of this lovely flat in a sought-after location.

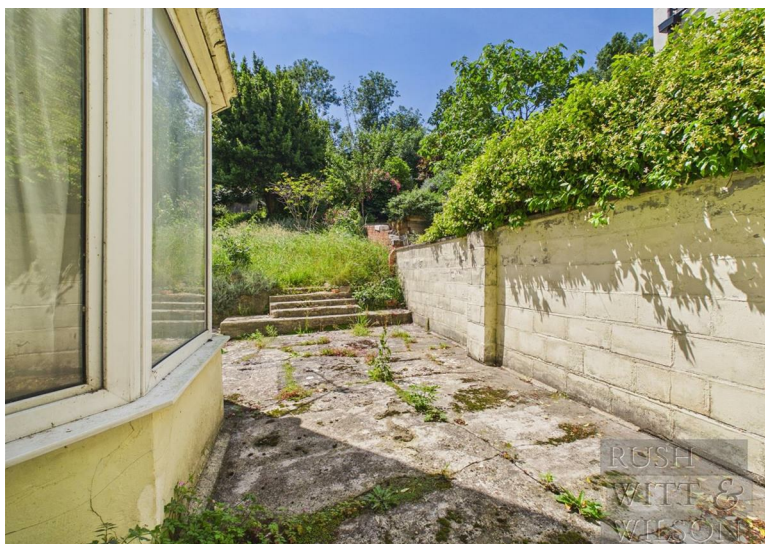



RUSH
WITT &
WILSON



RUSH
WITT &
WILSON



RUSH
WITT &
WILSON



RUSH
WITT &
WILSON



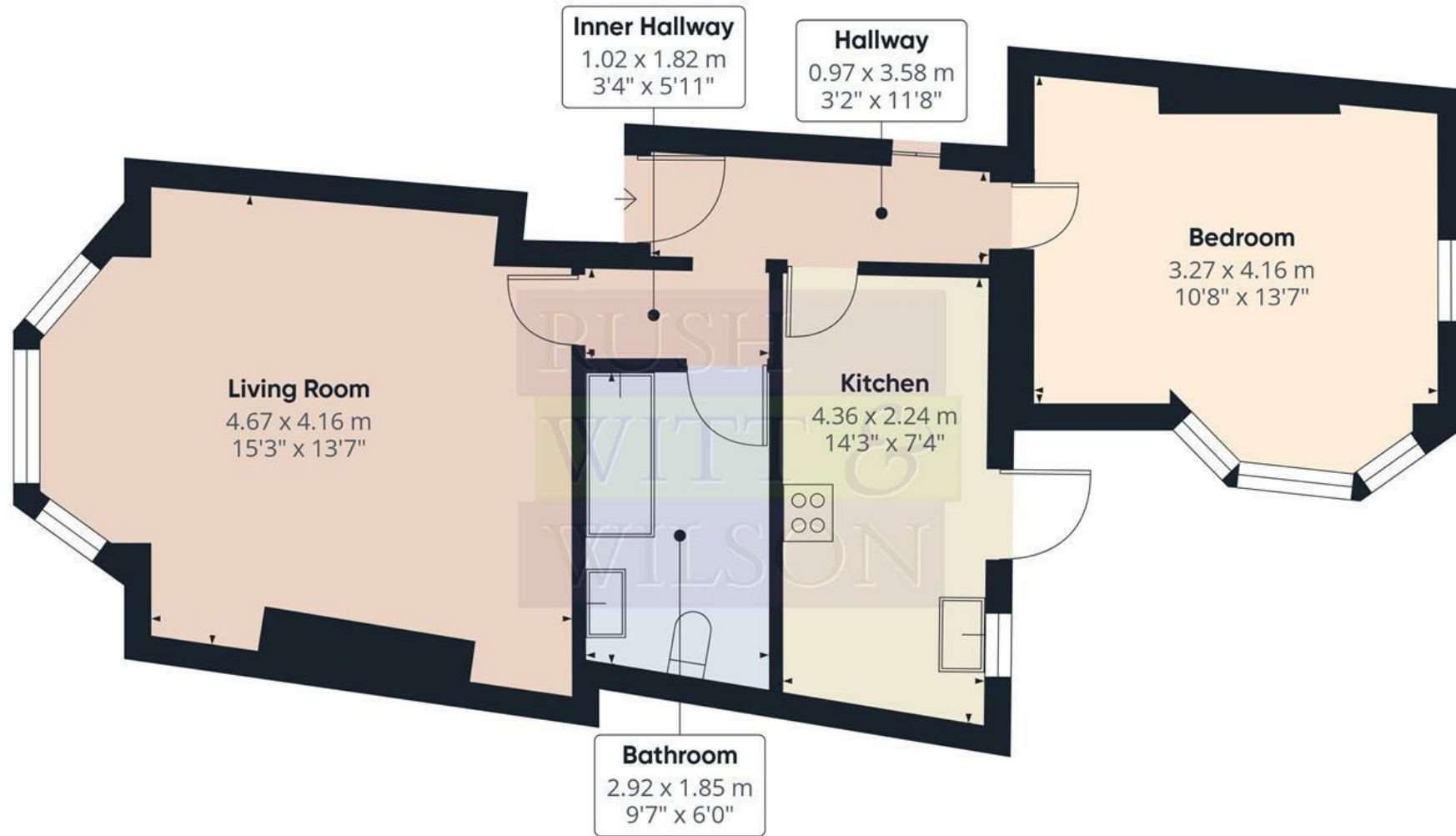

Approximate total area⁽¹⁾

56.3 m²
605 ft²

(1) Excluding balconies and terraces

Calculations reference the RICS IPMS 3C standard. Measurements are approximate and not to scale. This floor plan is intended for illustration only.

GIRAFFE360



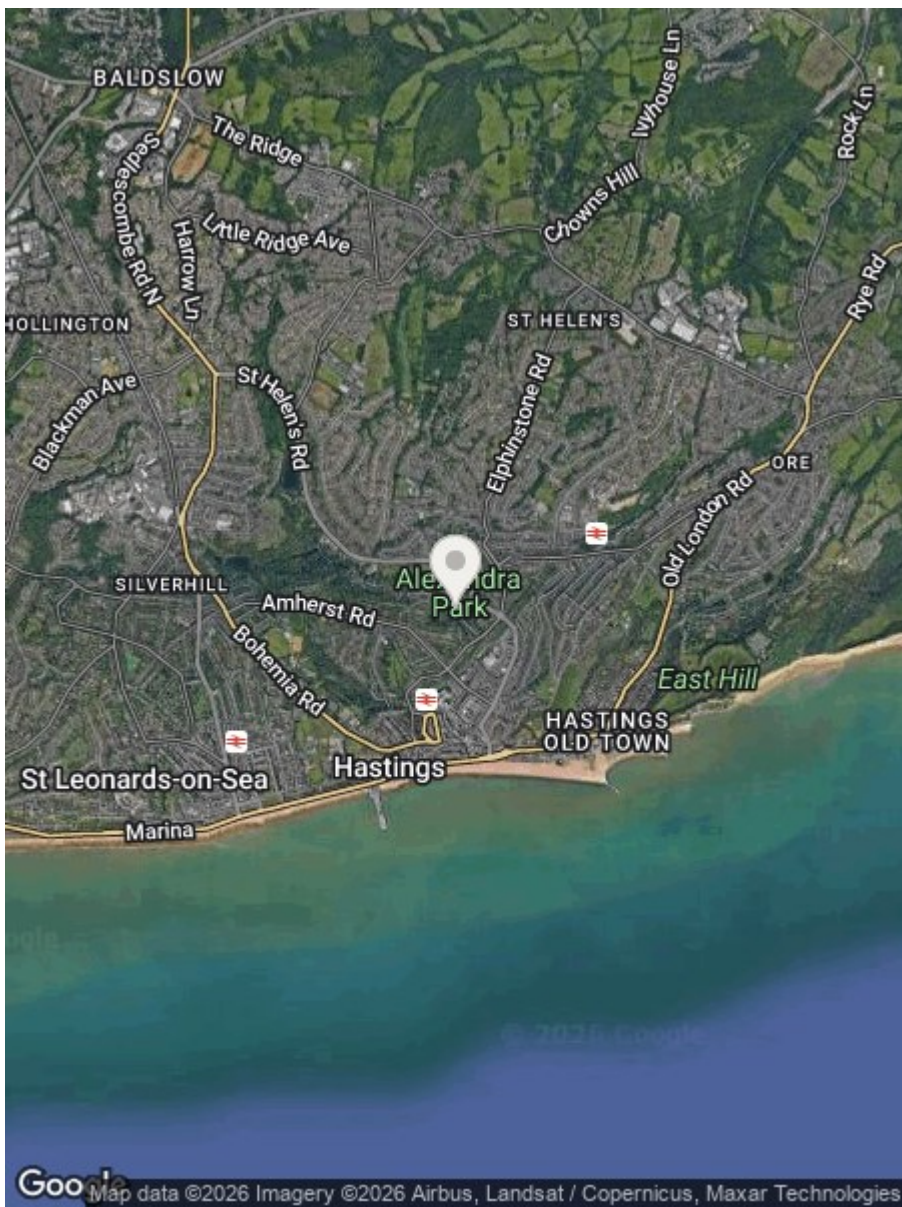

Energy Efficiency Rating		
	Current	Potential
Very energy efficient - lower running costs		
(92 plus) A		
(81-91) B		
(69-80) C		
(55-68) D	68	75
(39-54) E		
(21-38) F		
(1-20) G		
Not energy efficient - higher running costs		
England & Wales	EU Directive 2002/91/EC	

Environmental Impact (CO ₂) Rating		
	Current	Potential
Very environmentally friendly - lower CO ₂ emissions		
(92 plus) A		
(81-91) B		
(69-80) C		
(55-68) D		
(39-54) E		
(21-38) F		
(1-20) G		
Not environmentally friendly - higher CO ₂ emissions		
England & Wales	EU Directive 2002/91/EC	

Council Tax Band - A

Fixtures and fittings: A list of the fitted carpets, curtains, light fittings and other items fixed to the property which are included in the sale (or may be available by separate negotiation) will be provided by the Seller's Solicitors.

Important Notice:

1. Particulars: These particulars are not an offer or contract, nor part of one. You should not rely on statements by Rush, Witt & Wilson in the particulars or by word of mouth or in writing ("information") as being factually accurate about the property, its condition or its value. Neither Rush, Witt & Wilson nor any joint agent has any authority to make any representations about the property, and accordingly any information given is entirely without responsibility on the part of the agents, seller(s) or lessor(s).
2. Photos, Videos etc: The photographs, property videos and virtual viewings etc. show only certain parts of the property as they appeared at the time they were taken. Areas, measurements and distances given are approximate only.
3. Regulations etc: Any reference to alterations to, or use of, any part of the property does not mean that any necessary planning, building regulations or other consent has been obtained. A buyer or lessee must find out by inspection or in other ways that these matters have been properly dealt with and that all information is correct.
4. VAT: The VAT position relating to the property may change without notice.
5. To find out how we process Personal Data, please refer to our Group Privacy Statement and other notices at <https://rushwittwilson.co.uk/privacy-policy>

**RUSH
WITT &
WILSON**

**Residential Estate Agents
Lettings & Property Management**



**Rother House Havelock Road
Hastings
East Sussex
TN34 1BP
Tel: 01424 442443
hastings@rushwittwilson.co.uk
www.rushwittwilson.co.uk**